

## Warnings:

- Rotor may become very hot during use. Avoid contact during and directly after riding.
- Rotor may contain sharp edges. Avoid contact while the wheel is spinning.
- Installation should only be completed by a trained technician. Improper installation could cause serious or fatal injuries.
- This product is designed for cross country use only.

## Maintenance and Break-in:

- A break-in period of 30-40 complete, moderate stops is required for the rotors to reach full braking power.
- Disc rotor may be periodically cleaned with Isopropyl Alcohol.
- Rotor bolts should be periodically checked for proper tightening torque.
- To replace batteries, rotor must first be removed. Refer to page 36 of owner's manual for additional instructions.

## Assembly Instructions:

This kit includes:

1x

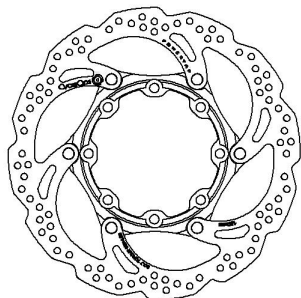

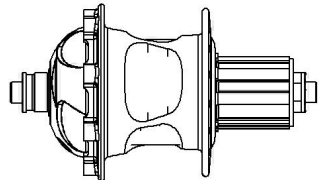

160mm PowerTap Disc Rotor

1x



MTB Disc PowerTap 2.4 Hub

16x  M5 x 0.2mm shims

8x  M5 x 10mm bolts

1x  T25 Torx Wrench

Assemble as shown:

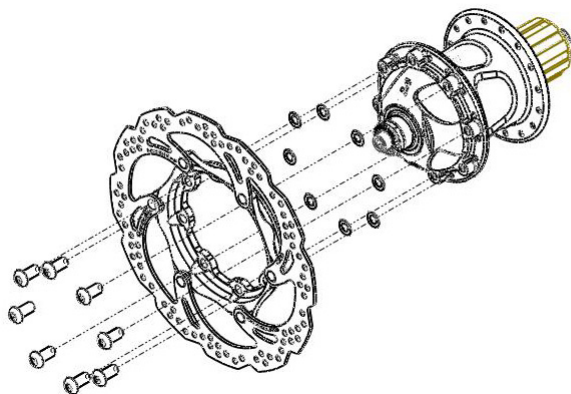

## Notes:

- Tighten bolts to 55in-lbs, in star pattern.
- Optional—M5x0.2mm shims may be used between hub and rotor to center rotor in caliper.

## Additional Information/Replacement Parts

- For replacement rotors, please contact Saris.
- See complete Owner's Manual for additional information.

## Hub/Wheel Building Information:

- Spoke Holes—32
- Disc Rotor Diameter—160mm
- Hub Over-Locknut Distance —135mm
- Non-drive side flange dimensions:
  - Flange Diameter—74.0mm
  - Center to Flange—29.8mm
- Drive-side flange dimensions:
  - Flange Diameter—70.0mm
  - Center to Flange—19.9mm
- **IMPORTANT:** For your safety, the non-drive side of the PowerTap hub must be built with at least a 3x lacing pattern. Because of the patented PowerTap design, torque is transferred through the hub to the non-drive side. Failure to adhere to this precaution will void the warranty.